

MT4.18™

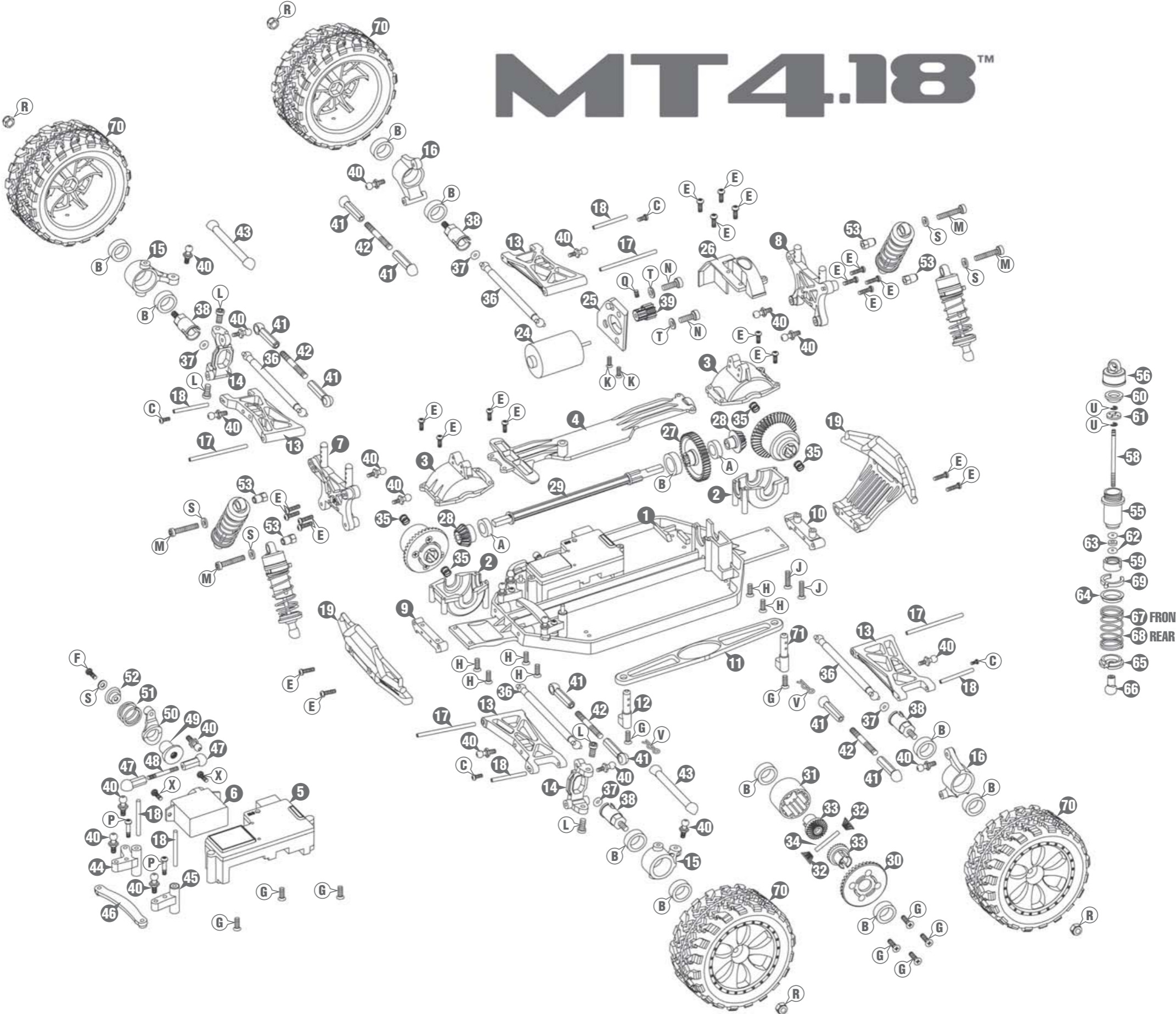

#	Item Description	Available in Stock #
1	Chassis.....	DIDC1028
2	Lower Gearbox Half.....	DIDC1006
3	Upper Gearbox Half.....	DIDC1006
4	Upper Chassis Brace.....	DIDC1021
5	RE-18 Receiver/ESC Unit.....	DIDM1000
6	Servo.....	DIDM1001
7	Shock Tower Front.....	DIDC1048
8	Shock Tower Rear.....	DIDC1049
9	Front Hinge Pin Holder.....	DIDC1024
10	Rear Hinge Pin Holder.....	DIDC1024
11	Battery Hold Down.....	DIDC1026
12	Front Battery Post.....	DIDC1028, DIDC1063
13	Suspension Arm.....	DIDC1018
14	Front Hub Carrier.....	DIDC1012
15	Steering Knuckle.....	DIDC1013
16	Rear Hub.....	DIDC1014
17	2x36.5mm Pin (Inner Hinge).....	DIDC1035
18	2x22mm Pin (Outer Hinge, Steering).....	DIDC1036
19	Bumper.....	DIDC1046
24	M370 Motor.....	DIDC1030
25	Motor Mount.....	DIDC1031
26	Spur Gear Cover.....	DIDC1027
27	45 Tooth Spur Gear.....	DIDC1005

#	Item Description	Available in Stock #
28	15 Tooth Differential Pinion Gear.....	DIDC1003
29	Center Drive Shaft.....	DIDC1007
30	38T Differential Ring Gear..	DIDC1003, DIDC1061
31	Differential Case.....	DIDC1004, DIDC1061
32	Diff Bevel Gear (Small).....	DIDC1002, DIDC1061
33	Diff Bevel Gear (Large).....	DIDC1002, DIDC1061
34	2x16.5mm Pin (Diff Gear Pin)..	DIDC1037, DIDC1061
35	Dogbone Spring.....	DIDC1002, DIDC1062
36	Dogbone.....	DIDC1009
37	2x5mm O-Ring.....	DIDC1008, DIDC1062
38	Axle.....	DIDC1008
39	11T Pinion Gear (.6 Mod, 2mm Shaft).....	DIDC1047
40	Ball Stud.....	DIDC1034
41	Ball Cup (Long).....	DIDC1042
42	Camber Rod.....	DIDC1042
43	Tie Rod.....	DIDC1042
44	Steering Bell Crank (Right).....	DIDC1010
45	Steering Ball Crank (Left).....	DIDC1010
46	Steering Drag Link.....	DIDC1010
47	Ball Cup (Short).....	DIDC1042
48	Steering Rod.....	DIDC1042
49	Servo Saver Spline.....	DIDC1011
50	Servo Saver Arm.....	DIDC1011

#	Item Description	Available in Stock #
51	Servo Saver Spring.....	DIDC1011
52	Servo Saver Cap.....	DIDC1011
53	Upper Shock Mount.....	DIDC1029
55	Shock Body.....	DIDC1016
56	Shock Cap.....	DIDC1016
58	Shock Shaft.....	DIDC1016
59	Shock Seal Retainer.....	DIDC1016
60	Shock Diaphragm.....	DIDC1016
61	Shock Piston.....	DIDC1016
62	Shock O-Ring.....	DIDC1016
63	Shock O-Ring Spacer.....	DIDC1016
64	Upper Shock Spring Retainer.....	DIDC1016
65	Lower Shock Spring Retainer.....	DIDC1016
66	Shock End.....	DIDC1016
67	Long Shock Spring (Med-Soft/Yellow).....	DIDC1038
68	Long Shock Spring (Med-Heavy/Blue).....	DIDC1059
69	Shock Pre-Load Spacer 1mm.....	DIDC1016
69	Shock Pre-Load Spacer 2mm.....	DIDC1016
69	Shock Pre-Load Spacer 4mm.....	DIDC1016
70	Wheel/Tire/Foam Insert Assembled.....	DIDC1056
71	Rear Battery Post.....	DIDC1028, DIDC1063

#	Item Description	Available in Stock #
HARDWARE		
A	6x10mm Ball Bearing.....	DIDC1070
B	8x12mm Ball Bearing.....	DIDC1071
C	2x4mm Round Head Screw.....	DIDC1057
E	2x8mm Round head Screw.....	DIDC1057
F	2x10mm Round Head Screw.....	DIDC1057
G	2x8mm Flat Head Screw.....	DIDC1057
H	2x10mm Flat Head Screw.....	DIDC1057
J	2x14mm Flat Head Screw.....	DIDC1057
K	2.5x8mm Flat Head Screw.....	DIDC1057
L	2.5x8mm Socket Head Cap Screw.....	DIDC1057
M	2.5x14mm Socket Head Cap Screw.....	DIDC1057
N	3x6mm Socket Head Cap Screw.....	DIDC1057
P	2x8mm Round Head Shoulder Screw.....	DIDC1057
Q	3x3mm Set Screw.....	DIDC1057
R	3mm Nylon-Insert Lock Nut... ..	DIDC1001, DIDC1057
S	2.6x5mm Washer.....	DIDC1057
T	3x6mm Washer.....	DIDC1057
U	1.5mm E-Clip.....	DIDC1057
V	Body Clip (Small).....	DIDC1000, DIDC1057
X	2x6mm S/T Round Head Screw.....	DIDC1057