

BX4.18™

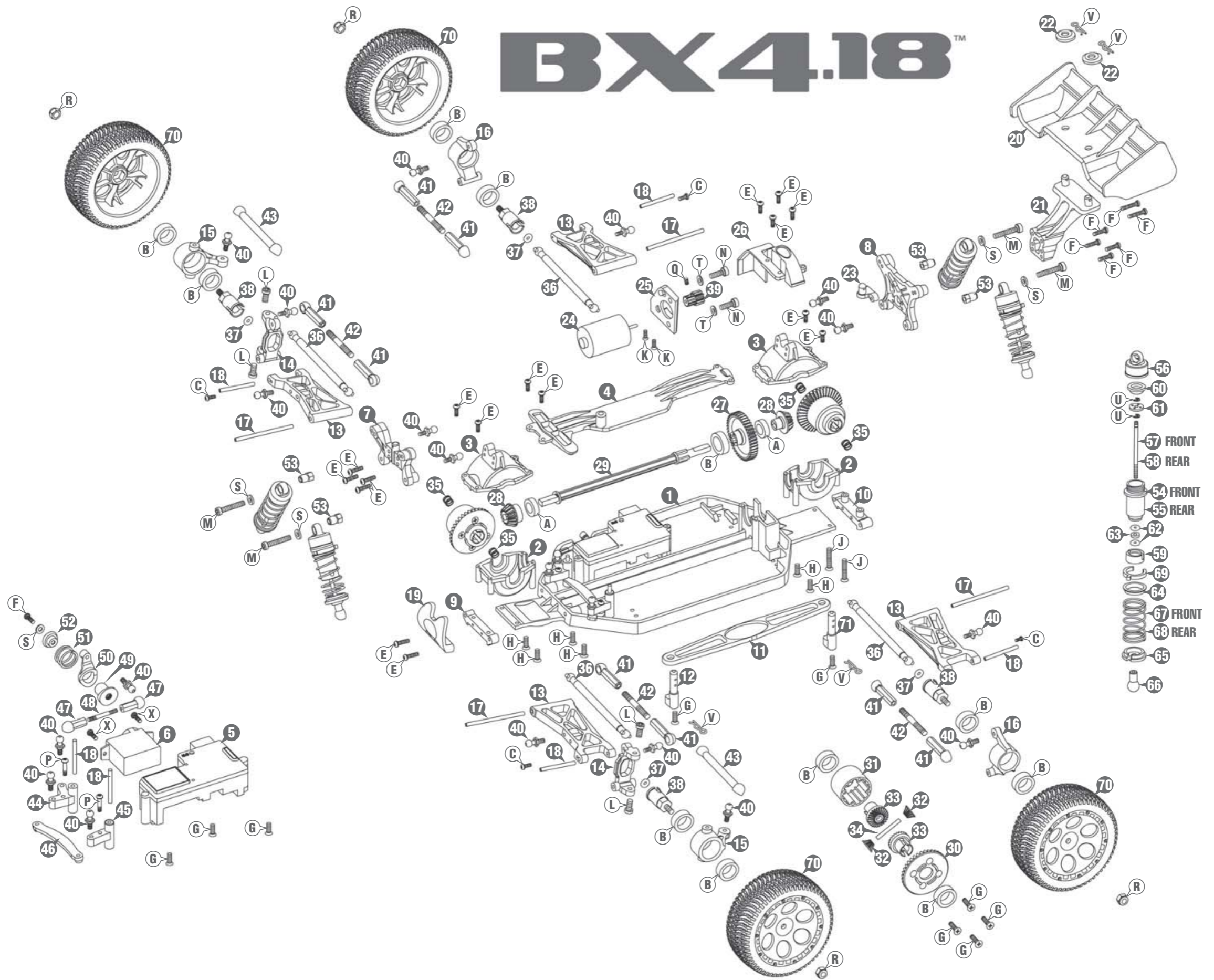

#	Item Description	Available in Stock #	#	Item Description	Available in Stock #	#	Item Description	Available in Stock #	#	Item Description	Available in Stock #
1	Chassis	DIDC1028	24	M370 Motor	DIDC1030	48	Steering Rod	DIDC1042	74	Washer	DIDC1057
2	Lower Gearbox Half	DIDC1006	25	Motor Mount	DIDC1031	49	Servo Saver Splines	DIDC1011	75	Washer	DIDC1057
3	Upper Gearbox Half	DIDC1006	26	Spur Gear Cover	DIDC1027	50	Servo Saver Arm	DIDC1011	76	Washer	DIDC1057
4	Upper Chassis Brace	DIDC1021	27	45 Tooth Spur Gear	DIDC1005	51	Servo Saver Spring	DIDC1011	77	Washer	DIDC1057
5	RE-18 Receiver/ESC Unit	DIDM1000	28	15 Tooth Differential Pinion Gear	DIDC1003	52	Servo Saver Cap	DIDC1011	78	Washer	DIDC1057
6	Servo	DIDM1001	29	Center Drive Shaft	DIDC1007	53	Upper Shock Mount	DIDC1029	79	Washer	DIDC1057
7	Front Shock Tower	DIDC1019	30	38 Tooth Differential Ring Gear	DIDC1003, DIDC1061	54	Front Shock Body (Short)	DIDC1015	80	Washer	DIDC1057
8	Rear Shock Tower	DIDC1020	31	Differential Case	DIDC1004, DIDC1061	55	Rear Shock Body (Long)	DIDC1016	81	Washer	DIDC1057
9	Front Hinge Pin Holder	DIDC1024	32	Diff Bevel Gear (Small)	DIDC1002, DIDC1061	56	Shock Cap	DIDC1015, DIDC1016	82	Washer	DIDC1057
10	Rear Hinge Pin Holder	DIDC1024	33	Diff Output/Bevel Gear (Large)	DIDC1002, DIDC1061	57	Front Shock Shaft (Short)	DIDC1015	83	Washer	DIDC1057
11	Battery Hold Down	DIDC1026	34	2x16.5mm Pin (Diff Gear Pin)	DIDC1037, DIDC1061	58	Rear Shock Shaft (Long)	DIDC1016	84	Washer	DIDC1057
12	Front Battery Post	DIDC1028, DIDC1063	35	Dogbone Spring	DIDC1002, DIDC1062	59	Shock Seal Retainer	DIDC1015, DIDC1016	85	Washer	DIDC1057
13	Suspension Arm	DIDC1018	36	Dogbone	DIDC1009	60	Shock Diaphragm	DIDC1015, DIDC1016	86	Washer	DIDC1057
14	Front Hub Carrier (C-Hub)	DIDC1012	37	2 x 5mm O-Ring	DIDC1008, DIDC1062	61	Shock Piston	DIDC1015, DIDC1016	87	Washer	DIDC1057
15	Steering Knuckle	DIDC1013	38	Axle	DIDC1008	62	Shock O-Ring	DIDC1015, DIDC1016	88	Washer	DIDC1057
16	Rear Hub	DIDC1014	39	12T Pinion Gear	DIDC1032	63	Shock O-Ring Spacer	DIDC1015, DIDC1016	89	Washer	DIDC1057
17	2x36.5mm Pin (Inner Hinge Pin)	DIDC1035	40	Ball Stud	DIDC1034	64	Upper Shock Spring Retainer	DIDC1015, DIDC1016	90	Washer	DIDC1057
18	2x22mm Pin (Outer Hinge Pin, Steering Pivot)	DIDC1036	41	Ball Cup (Long)	DIDC1042	65	Lower Shock Spring Retainer	DIDC1015, DIDC1016	91	Washer	DIDC1057
19	Bumper	DIDC1025	42	Camber Rod	DIDC1042	66	Shock End	DIDC1015, DIDC1016	92	Washer	DIDC1057
20	Rear Wing	DIDC1022	43	Tie Rod	DIDC1042	67	Shock Spring Short (Med/Lt Blue)	DIDC1043	93	Washer	DIDC1057
21	Wing Mount	DIDC1023	44	Steering Bell Crank (Right)	DIDC1010	68	Shock Spring Long (Soft/Red)	DIDC1039	94	Washer	DIDC1057
22	Wing Washer	DIDC1022	45	Steering Ball Cranks (Left)	DIDC1010	69	Shock Pre-Load Spacers	DIDC1015, DIDC1016	95	Washer	DIDC1057
23	Rear Body Mount	DIDC1025	46	Steering Drag Link	DIDC1010	70	Wheel/Tire/Foam Assembled	DIDC1017	96	Washer	DIDC1057
			47	Ball End (Short)	DIDC1042	71	Rear Battery Post	DIDC1028, DIDC1063	97	Washer	DIDC1057